

Specification	Multi-purpose clamp for 8-10mm conductor. Copper. Thread in the lower part. Weight: 102g Reference Standard: DIN EN 62561-1
Article No.	42 04 20

Customs tariff No.: 85389099

Suitable as well for use as T-, parallel and cross-clamp.

Experience shows that this clamp is also used in practice as saddle clamp if a sufficient contact surface can be guaranteed.

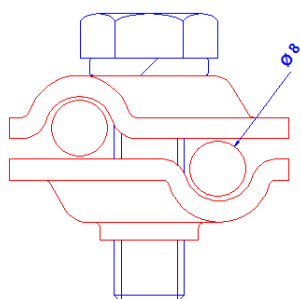
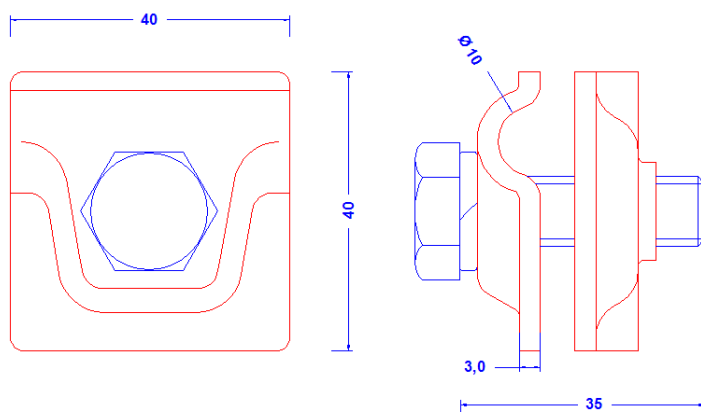
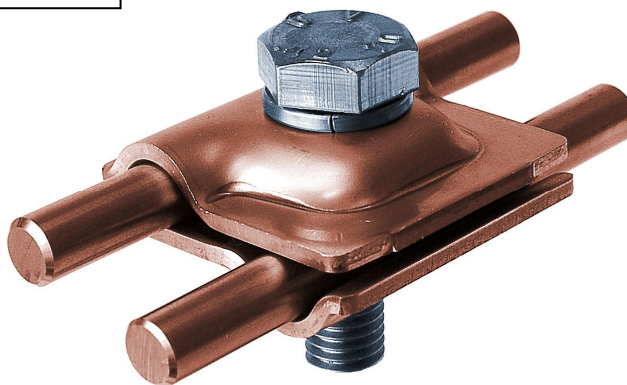

**This product is build to stand
a current of 100 kA.**

Description	RoHS2 (Guideline 2011/65/EU) and REACH (Regulation (EG) No.1907/2006): The substance-requirements and all other requirements of this regulations are observed by this product.
Material of the clamp	Copper
Conductor leading	2 x 8-10mm conductor parallel or crosswise.
Screw connection (all stainless steel)	Screw: DIN933M10X35, spring washer: 10mm
Remarks	Upper part of the clamp with a square hole 11x11mm. Lower part with a thread M10.