

Specification	Tube clamp for cable with 23mm Ø with a rippled bottom plate 45x24mm, with a hole 6,2mm, with polyamide slotted screw M6. Weight: 30g Reference standard: DIN EN 62561-4
Article No.	61 01 18

Customs tariff No.: 85389099

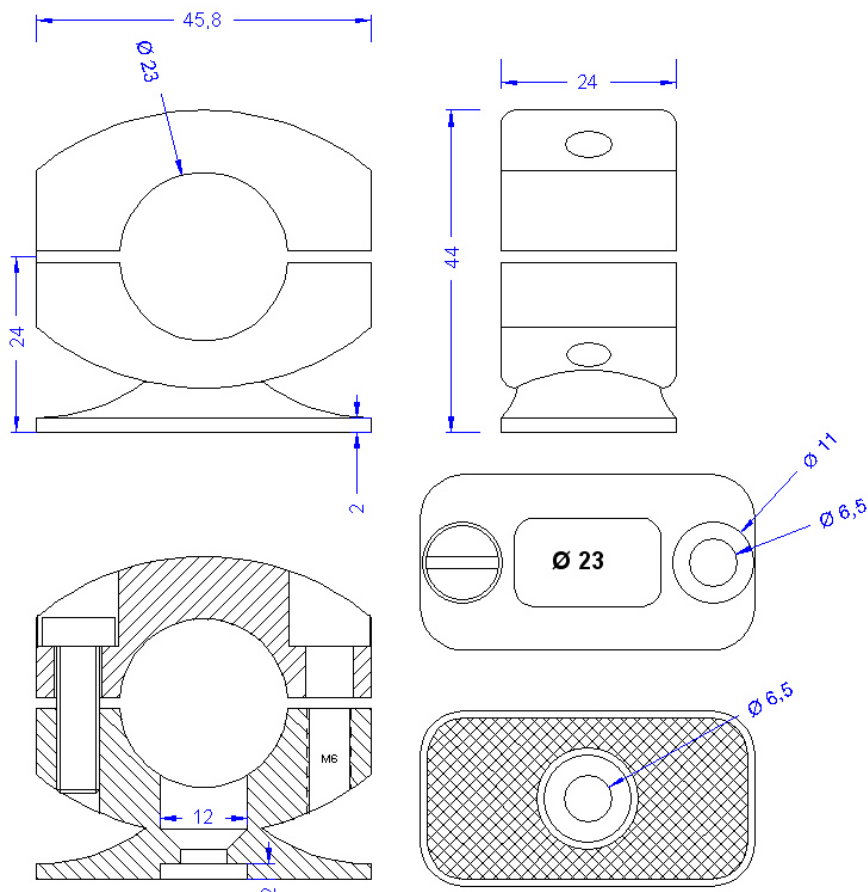

Description	RoHS2 (Guideline 2011/65/EU) and REACH (Regulation (EG) No.1907/2006): The substance-requirements and all other requirements of these regulations are observed by this product.
Holder	Tube clamp for cable with 23mm Ø with a rippled bottom plate 45x24mm, with a hole 6,2mm
Screws	2 x DIN84M6X20POLY (slotted screw made of polyamide)
Material	Polyamide, grey. Colour No. RAL 7000. UV- and heat stabilized, cold impact resistant. Halogen free.