

Specification	Worm drive clamp for pipe diameter 120-140mm, with nose for 8mm conductor. Stainless steel, galvanized copper-plated. Weight: 40g Reference Standard: DIN EN 62561-1
Article No.	37 23 20

Customs tariff No.: 85389099

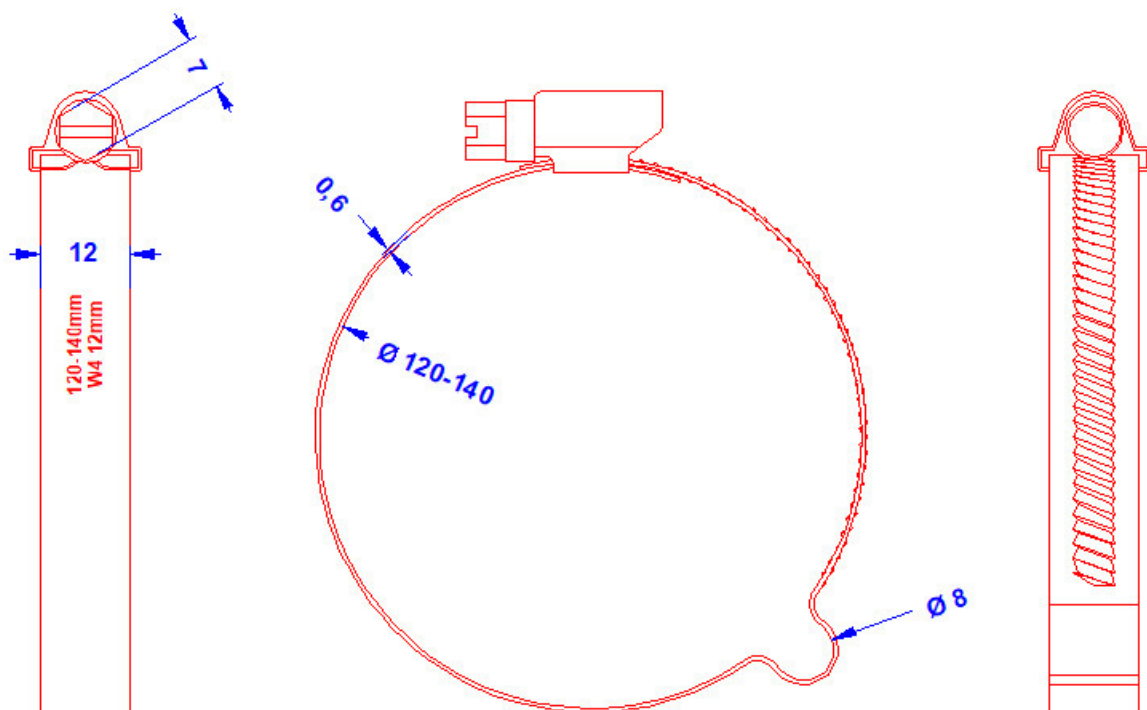

Description	RoHS2 (Guideline 2011/65/EU) and REACH (Regulation (EG) No.1907/2006): The substance-requirements and all other requirements of this regulations are observed by this product.
Worm drive clamp	Adaptable for pipe diameter 120-140mm. With slotted hexagon head screw, width across flats 6. Stainless steel 1-4301, galvanized copper-plated.