

Spezifikation	Saddle clamp for 6-8mm conductor with round, twistable top part, for seams up to 6mm. With 4 stainless steel screws M6. Top part hot galvanized steel. Base die-cast zinc. Weight: 110g Reference Standard: DINEN 62561-1
Article No.	51 01 40

Customs tariff No.: 85389099

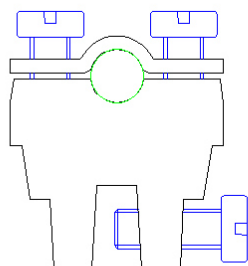

Front

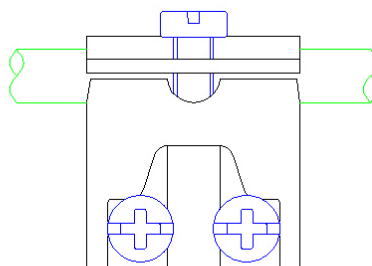

Side

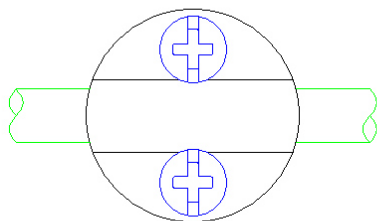

Top

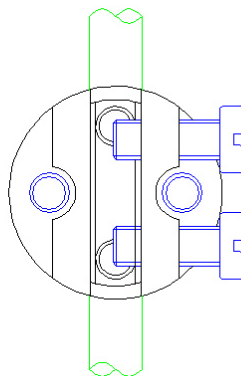

Bottom

Description	RoHS2 (Guideline 2011/65/EU) and REACH (Regulation (EG) No.1907/2006): The substance-requirements and all other requirements of these regulations are observed by this product.
Material of the clamp	Hot dip galvanized steel.
Material of the base	Die-cast zinc
Screw connection (all stainless steel)	2xDIN84M6X16; 2xDIN84M6X12.
Clamping range (seam)	Up to 6,0mm
Conductor leading	6-8mm