

<b>Specification</b>	Tube for concrete-filling, empty for a maximum of 15 kg filling weight as plastic tub with an intake for a 16mm Ø air termination rod and a stainless steel wedge for self-filling with gravel or concrete. Weight: 1,2 kg
<b>Article No.</b>	<b>48 04 50</b>

Customs tariff No.: 85389099

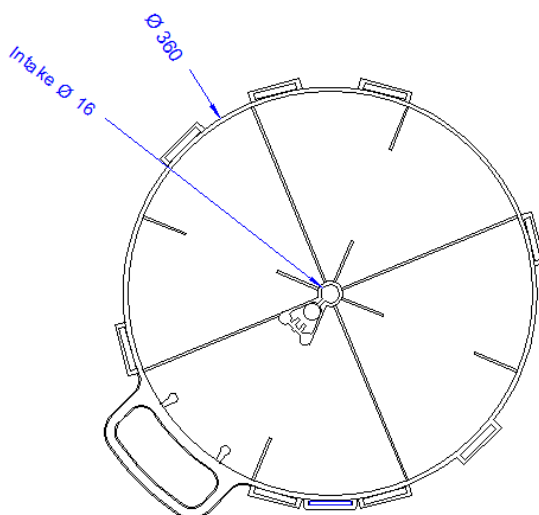

**Top**

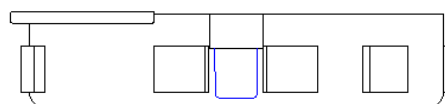

**Side**

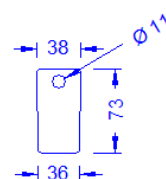

**Stainless  
steel  
wedge**

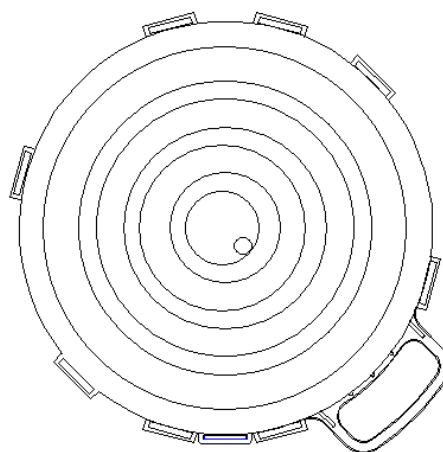

**Bottom**

<b>Description</b>	
<b>Material of the tube</b>	<b>Plastic, black.</b>
<b>Material of the wedge</b>	<b>Stainless steel</b>
<b>Intake</b>	<b>16mm Ø</b>