

Specification	Mini-Multi-purpose clamp for 6-8mm conductor, only one half, with stainless steel screw connection. Copper. Weight: 35g Reference Standard: DIN EN 62561-1
Article-No.	42 02 20

Customs tariff No.: 85389099

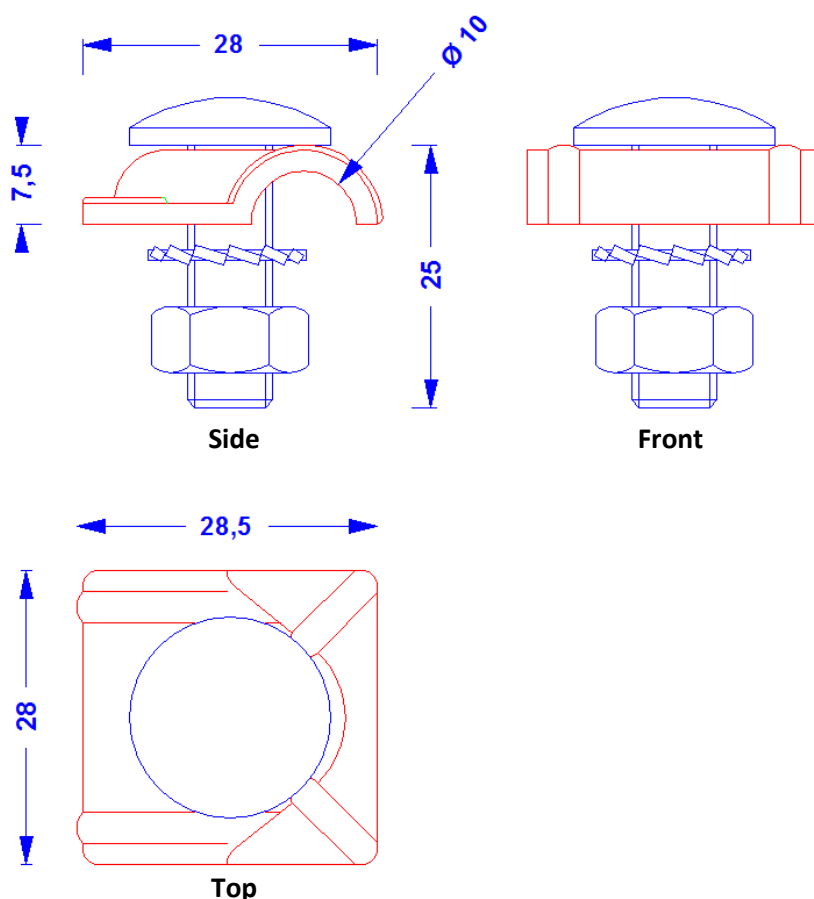

Description	RoHS2 (Guideline 2011/65/EU) and REACH (Regulation (EG) No.1907/2006): The substance-requirements and all other requirements of this regulations are observed by this product.
Material of the clamp	Copper
Conductor leading	6-8mm
Screw connection (all made of stainless steel)	DIN603M8x25, DIN6798A-8,4, DIN934M8