

<b>Specification</b>	Adhesive plate for cond. 8mm , with pivotable holder , height 100mm for flat roofs, made of stainless steel , base 70 x 70mm. Grey. Weight: 75g
<b>Article No.</b>	<b>46 22 14</b>

Customs tariff No.: 85389099

**DIN EN62561-4:** „This standard **does not cover** the fixing of conductor fasteners to the fabric/membrane/ gravel roofing of structures due to the vast number and types used in modern day construction.“

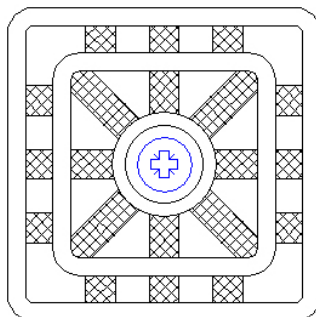

**Bottom**

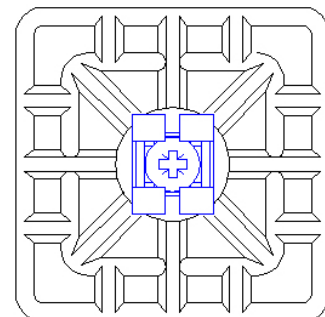

**Top**

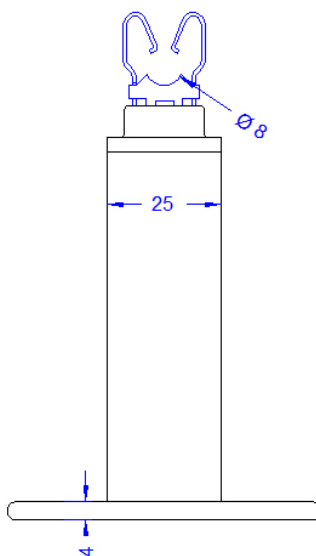

**Front**

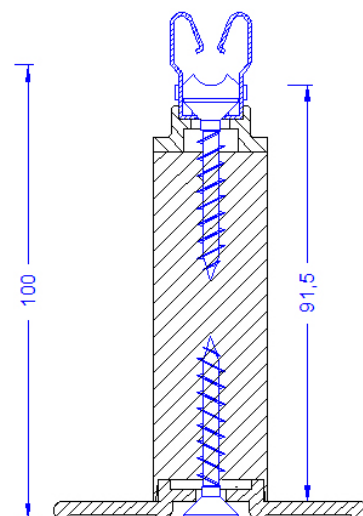

**Cut**

<b>Description</b>	RoHS2 (Guideline 2011/65/EU) and REACH (Regulation (EG) No.1907/2006): The substance-requirements and all other requirements of this regulations are observed by this product.
<b>Holder</b>	<b>Stainless steel for 8mm conductor.</b>
<b>Screws (all stainless steel)</b>	<b>2 x tensioning screws Stainless steel.</b>
<b>Spacer</b>	<b>Polyamide-piece GRP-reinforced, 77mm long, grey.</b>
<b>Bottom plate</b>	<b>Made of polyamide. Colour RAL7000 (grey). Cold impact resistant and UV-stabilized to the highest degree. Halogen-free.</b>
<b>Processing on the roof</b>	<b>To be glued on hot and cold bitumen.</b>