

<b>Specification</b>	Clamping screw connector for 7-11mm round conductor, with thread M10 with nut made of stainless steel copper-plated and clamp made of red brass. Stainless steel, copper-plated. Weight: 77g Ref. standard: DIN EN 62561-1.
<b>Article No.</b>	<b>52 01 20</b>

Customs tariff No.: 85389099

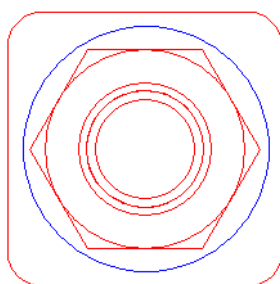

23,5



Bottom

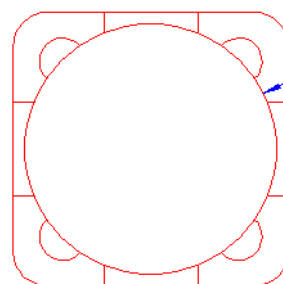

Top

Ø 21,5

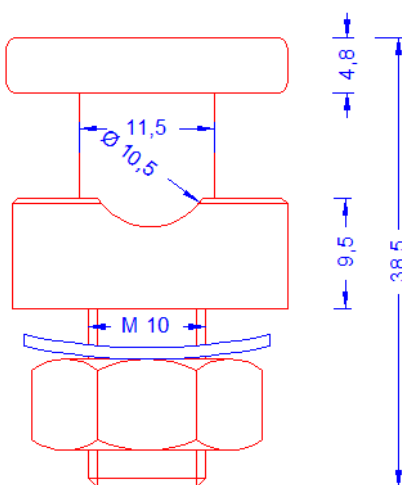

Side

4,8  
9,5  
38,5

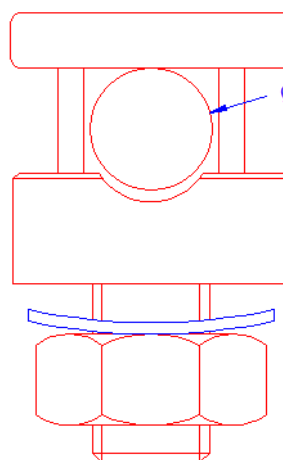

Front

Ø 10,4

## Description

**Material of the eye bolt**

RoHS2 (Guideline 2011/65/EU) and REACH (Regulation (EG) No.1907/2006): The substance-requirements and all other requirements of these regulations are observed by this product.

**Stainless steel, copper-plated**

**Material of the clamp**

**Red brass**

**Nut / spring washer (all stainless steel)**

**DIN934M10, copper-plated. / DIN137M10**

**Conductor leading**

**7-11mm**